

# HRH0928LRE

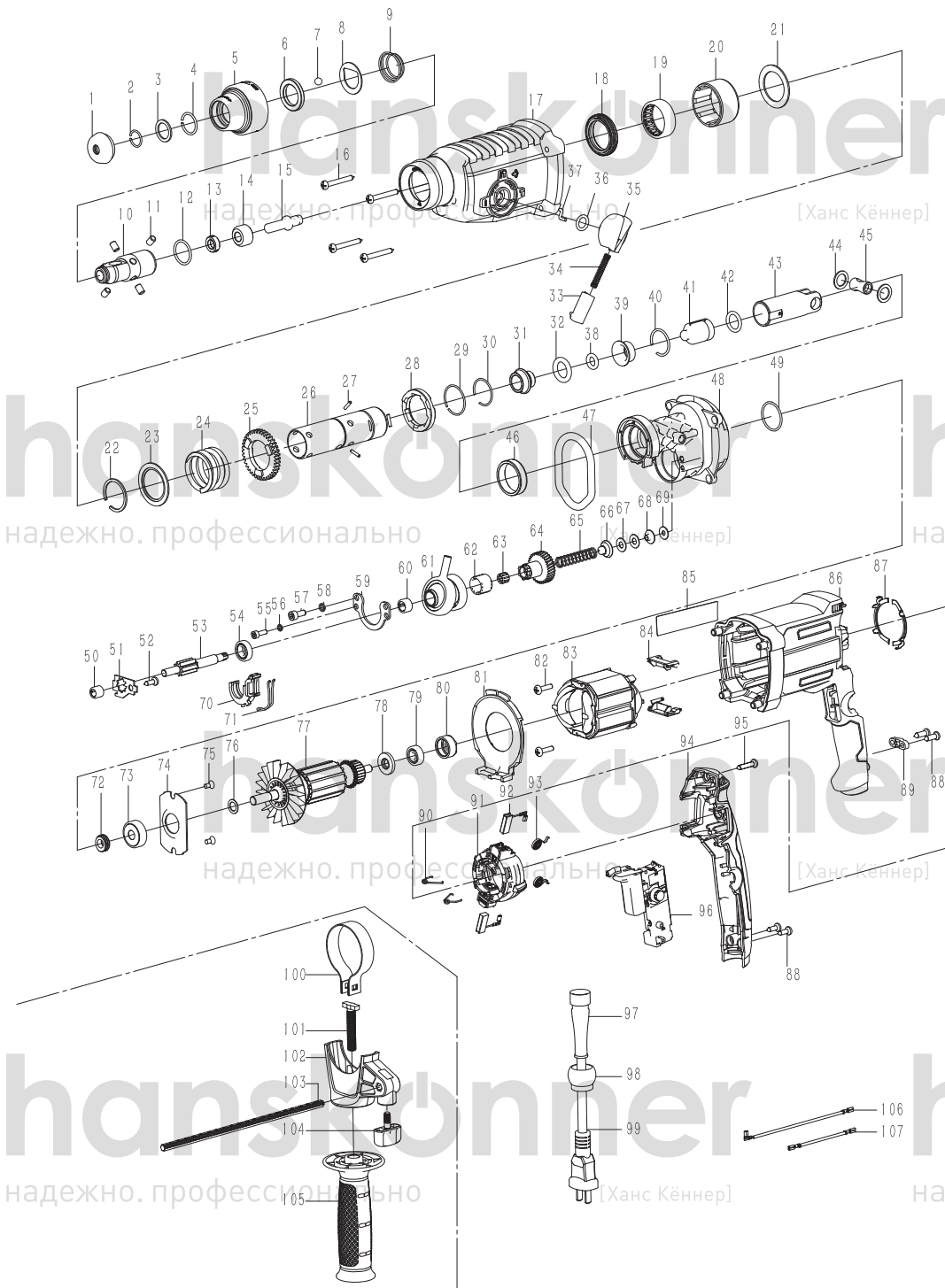

NO.	DESCRIPTION	NO.	DESCRIPTION
1	Cap	55	Screw M4*12
2	Ring spring $\Phi 14 \times 1.5$	56	Spring washer 4
3	Washer $\Phi 16 \times \Phi 22 \times 1.5$	57	Screw M5*12
4	Ring spring 18.5*2	58	Spring washer 5
5	Chuck cover	59	rocker bearing plate
6	Iron ring	60	Needle bearing 0908
7	Steel ball $\Phi 7.144$	61	rocker bearing
8	Gasket	62	Needle bearing K15*18*14
9	Spring	63	Needle bearing
10	Tool hold complete	64	Gear shaft
11	Pin $\Phi 6 \times 8.8$	65	Clutch spring
12	O ring $\Phi 20.9 \times 2.1$	66	Clutch spring seat
13	Oil seal $\Phi 16 \times \Phi 8.5 \times 5$	67	Washer
14	Sleeve	68	Clutch spring seat(iron)
15	Impact bolt	69	Rubber pad $\Phi 4 \times \Phi 12 \times 0.6$
16	Screw ST4.5*42	70	Plastic fork
17	Gear box (3 mode)	71	Ring spring
18	Oil seal $\Phi 41 \times \Phi 30 \times 7$	72	Oil guide ring
19	Needle bearing HK3012	73	Bearing 609
20	Sleeve	74	609 bearing gland
21	Washer $\Phi 30.2 \times \Phi 43 \times 1.5$	75	Screw M4*8
22	Ring spring $\Phi 33 \times \Phi 28 \times 1.5$	76	Retaining ring 14*9*0.7
23	Washer $\Phi 30.2 \times \Phi 43 \times 1.5$	77	Armature
24	Spring	78	Dust proof ring
25	Big gear	79	Bearing 607
26	Cylinder	80	Bearing housing 607
27	Pin $\Phi 2.5 \times 12$	81	Guide ring
28	Ring	82	Screw ST4.2*16
29	Ring spring $\Phi 27.5 \times 1.5$	83	Stator
30	Ring spring $\Phi 27.5 \times 1.5$	84	Stator pin Ass.
31	Hammer rod sleeve	85	Sticker
32	O ring $\Phi 16.1 \times 4.5$	86	Motor housing
33	Knob	87	Semicircular Spring washer
34	Spring	88	Screw ST4.2*16
35	Shifting stall knob	89	Switch board
36	O ring 10.6*2.7	90	Torsion spring
37	Iron core	91	Carbon brush frame
38	O ring 9*3.5	92	Carbon brush
39	Sleeve	93	Coil spring
40	Steel Cable Baffle Ring 28*2	94	Handle cover
41	Piston	95	Screw ST4.2*22
42	O ring 15*3	96	Switch
43	Aluminum cylinder	97	Cord guard
44	Gasket	98	Ball
45	Pin	99	Power cord
46	Stents bushing	100	Grip spring
47	O ring 52.2*7.4	101	T screw
48	Aluminum bracket	102	Grip base
49	O ring $\Phi 25.8 \times 1.8$	103	Depth gauge
50	Needle bearing KG0709	104	Side Handle button
51	Gasket	105	Handle
52	Screw ST4.2*12	106	Connection wire 120mm
53	Middle shaft	107	Connection wire 70mm
54	Bearing 699		